

Also available in our range

- Wall panel heaters
- Other sizes and widths on order

Contact us



Klimax Manufacturing (Pty) Ltd.
222 Van Dyk Road
Boksburg East, South Africa

SUNSHINE CEILING HEATING



User and installation guide

Specifications

Lightweight, low temperature, peel and stick ceiling panel heaters with adhesive tape on both sides.



Specifications

Product	Dimension	Watts	Volts	Area m ²
CP 6/6	600mm x 600mm	150	230	0.36m ²
CP 6/12	600mm x 1200mm	300	230	0.72m ²

Packing: 3 - 5 heaters per starter pack
2 - 4 heaters per extender pack

Any combination available.

- Simple, easy to install system. Peel and Stick
- For heating commercial and residential structures - new or remodeled
- For use as primary or supplementary heating
- Suitable for most ceiling boards including suspended ceilings
- Plug in connectivity (starter cable and splitter included)
- DIY version for retro fit

Precautions

- Heaters to be connected in parallel - system available - or supplied.
- Restricted to 3.4 kW per circuit (16A) (11 panels of 300W)
- These heaters are designed for ordinary non-insulating ceiling boards.
- The supply cord cannot be replaced. If the cord is damaged the appliance should be scrapped.
- Switch off electricity mains before installing.
- Install insulation on top of heater.
- Do not install light fittings under heater.

Warning

- This heater is not equipped with a device to control the room temperature. Do not use this heater in small rooms when they are occupied by persons not capable of leaving the room on their own, unless constant supervision is provided.
- This heater (system) must be connected to grounded power supply protected by ELCB, GFCI.
- The use of programmable room thermostats is recommended.

Installation for suspended ceilings



Carefully remove existing ceiling board from ceiling.



Clean all dust and dirt off the existing or new ceiling boards.

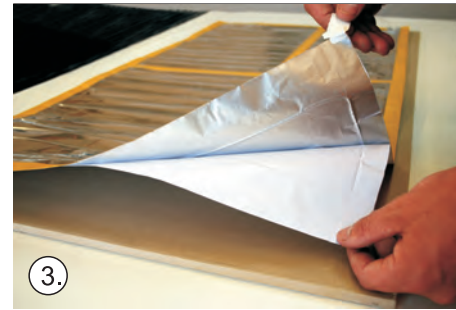

Place heater on top of ceiling board, silver side up.
Pull tab and peel protection paper.



Stick heater firmly down onto board.

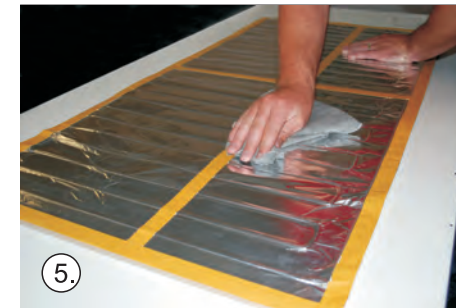

Ensure heater is flush against ceiling board and firmly stuck down into position.



Just peel double sided tape on silver side. Insulation can now be installed on top of heater.



Stick insulation down firmly onto the heater. The double sided tape will ensure heater stays in place.



Replace ceiling board with plenty of insulation on top.